

1. Please advise if we should proceed to design a telephony system that can be incorporated into Is it a system overhaul or a new installation?

IT'S A COMPLETE NEW INSTALLATION.

2. Can we as bidders allow/ quote for equipment that is not in the Bill of Materials, yet is required for a complete working solution?

AS STATED IN THE TENDER DOCUMENT THE ITEMS AND SOLUTION GIVEN WAS A GUIDE TO BIDDERS, WHO WILL USE IT TO COME UP WITH THE BEST COST EFFECTIVE SOLUTION. YES YOU CAN INCLUDE THE NECESSARY ITEMS.

3. If awarded the tender, will we use existing routes and trunking during installation?

THERE EXISTS TRUNKING IN THE BUILDING, HOWEVER WHERE THERE ARE NO TRUNKING IN PLACE THE VENDOR WILL USE THE MOST APPROPRIATE SIZE OF TRUNKING .

4. In reference to the above, we kindly request for an updated detailed breakdown of Bill of Materials for our reference, as during the survey, we were handed a Bill of materials which differs from the earlier received BOM in terms of quantities for both access control doors and cameras, type of cameras i.e dome/ bullet and location of the intruder system.

REFER TO TWO (2) ABOVE AND THE OBSERVATIONS YOU MADE DURING THE SITE SURVEY

5. Following the site visit undertaken on 13th February, kindly provide floor plans of the site to assist in cable and trunking estimation.

THE FLOOR PLANS ARE ATTACHED AT THE END OF THIS CLARIFICATION. KINDLY ZOOM ON THE MAPS FOR CLARITY.

6. After carrying out the site visit, we discovered the quantities in the BoQ is less than the ones required according to the survey. Which quantities should we follow?

REFER TO TWO (2) ABOVE AND THE OBSERVATIONS YOU MADE DURING THE SITE SURVEY

7. Also the maximum allowed cable length for a UTP cable is 100m between two termination points. However, the location of the control room where all the cameras are to terminate is beyond the required 100 meters. Can we add more cabinets and switches to maintain the recommended distance?

USE UTP ETHERNET EXTENDERS OR ANY OTHER VIABLE SOLUTION THAT IS COST EFFECTIVE.

8. During the site survey the client told us they require 50 IP CCTV Cameras but according to the Bill of Quantities in the tender document on Page 34 the figure is 40 IP CCTV cameras. Please clarify on the exact number of cameras in the BOQ stating Type of Camera, Areas to be used and Quantities?

REFER TO TWO (2) ABOVE AND THE OBSERVATIONS YOU MADE DURING THE SITE SURVEY

9. During the site survey we noticed that the existing cable route is full and I would like your clarification on whether we are to do new cable routes preferably metallic paint powder coated trunks that can house the IP CCTV, Access Control & Intruder Alarm System Cabling?

THE CCTV HAS A SEPARATE TRUNKING AND EXISTING CABLING WILL BE REMOVED.

10. You have requested we come up with a proposed design of the IP CCTV, Access Control & Intruder Alarm System, please provide us with a floor layout of the building so that we can be able to come up with the designs as it was not shown in the tender document?

REFER TO FIVE (5) ABOVE.

11. You have requested for an Intruder Alarm System and during the site survey you mentioned it is required for the DPP's Office and also Archives and in your document issued during the site survey it also shows that you require an alarm control system for the Man Traps at the Main Entry and the Reception Area and also you require and intruder sensor for the DPP's office and Archives Storage, please clarify on the exact locations of the Intruder Sensors and advice on;

ONLY IN THE DPP'S OFFICE

12. Magnetic Door Sensor Contacts to be installed Locations & Quantity

ONLY IN THE DPP'S OFFICE

13. Magnetic Window Sensors Contacts to be installed Locations and Quantity

ONLY IN THE DPP'S OFFICE

14. PIR (Passive Infra Red), Ultra Motion or Tomographic Sensors Location & Quantity Please state which type you require as you have mentioned you require Intruder Alarm System?

REFER TO TWO (2) ABOVE AND THE OBSERVATIONS YOU MADE DURING THE SITE SURVEY.

15. Please clarify on the expander module do you require a module that can expand to 8 additional zones or you require 8 expander modules as this seems to be too much for one controller?

WE REQUIRE AN EXPANDER MODULE THAT CAN EXPAND TO 8 ADDITIONAL ZONES.

16. During the site survey we noted that you require the IP CCTV Cameras to be installed in various locations and we would like clarification on the locations of the LAN Switch

Cabinets, we need clarification on whether we are allowed to quote for additional switches as the ones requested for in the BOQ will not be sufficient due to cabling and LAN switching standards?

REFER TO SEVEN (7) ABOVE.

17. For the DPP's office you requested that we quote for a Biometric Reader and a Card reader as 2 separate items, is it possible to quote for a Multifunctional Reader Terminal which is capable of doing Biometrics, Card & PIN as one Item?

YES.

18. At the DPP's Office you also requested that we quote for a Video Intercom Device but it's not in the BOQ please advise on this?

REFER TO TWO (2) ABOVE AND THE OBSERVATIONS YOU MADE DURING THE SITE SURVEY.

19. Finally I would like to suggest that at the DPP's office is it possible to just quote for one device which has Biometric, Card + PIN and Video intercom features instead of quoting for 3 separate devices?

REFER TO SEVENTEEN (17) ABOVE

20. You have indicated two switches only but when the survey was done we realize cameras exceed the recommended maximum distance of the UTP cable (90mtrs). This could only be achieved by have a number of interlinked switches with fiber close to camera points. Refer to item No. 2 of the bill of materials.

REFER TO SEVEN (7) ABOVE.

21. In the BQ you have not indicated the NVR Number of channels though from the BQ you need 40IP camera which translates to 40 channels, but in the technical specifications of the tender documents indicates that you require 32 Channels NVR. Kindly clarify if we can suggest a 64CH NVR which will be sufficient for all cameras. Refer to item No. 1 and 3 of Bill of materials.

THE 64 NVR SHOULD BE APPROPRIATE

22. Item No. 10 Mentions of Biometric card Printer. Do you mean you need access cards printer since in the technical specifications of the tender document suggest its an access card printer. Refer to Item No. 10 of the Bill of materials

IT IS A CARD PRINTER TO PRINT THE ACCESS CARDS FOR USERS.

23. In the technical specifications you have indicated a number of different types of cameras ie (indoor/outdoor dome, indoor/Outdoor Bullet camera but in the bill of materials indicates indoor dome camera only. However when we did the survey we realize there some areas requires indoor/outdoor bullet cameras. Kindly clarify. Refer to item No. 1.

REFER TO TWO (2) ABOVE AND THE OBSERVATIONS YOU MADE DURING THE SITE SURVEY

24. We needed clarification on the exact quantity of cameras to site, as you mentioned 40 and the other documentation has more, about 50 cameras

REFER TO TWO (2) ABOVE AND THE OBSERVATIONS YOU MADE DURING THE SITE SURVEY

25. On Access control you indicated 20 readers, is it 10 readers in and 10 readers out or?

REFER TO TWO (2) ABOVE AND THE OBSERVATIONS YOU MADE DURING THE SITE SURVEY

26. On doors you indicated 10 Magnetic locks, and 10 exit reader modules, kindly clarify?

REFER TO TWO (2) ABOVE AND THE OBSERVATIONS YOU MADE DURING THE SITE SURVEY

27. On the existing access controls, are we doing a major overhaul or will retain the existing access control?

REFER TO ONE (1) ABOVE

28. Are we quoting for the power supply for these 10 Magnetic locks?

REFER TO TWO (2) ABOVE AND THE OBSERVATIONS YOU MADE DURING THE SITE SURVEY

29. On the alarm system are we only capturing the DPP office only? We have 8 expanders with only 10 magnets and 4 panic buttons.

REFER TO FIFTEEN (15) ABOVE

30. WHAT IS SAS.

IT'S THE PUSH EXT BUTTON THAT MOSTLY IS USED BY THE SECRETARIES OR RECEPTIONSIST TO ALLOW ENTRY FOR VISITORS.

31. Tablet specifications?

IGNORE AND DO NOT QUOTE FOR THE TABLET.

THIRD FLOOR

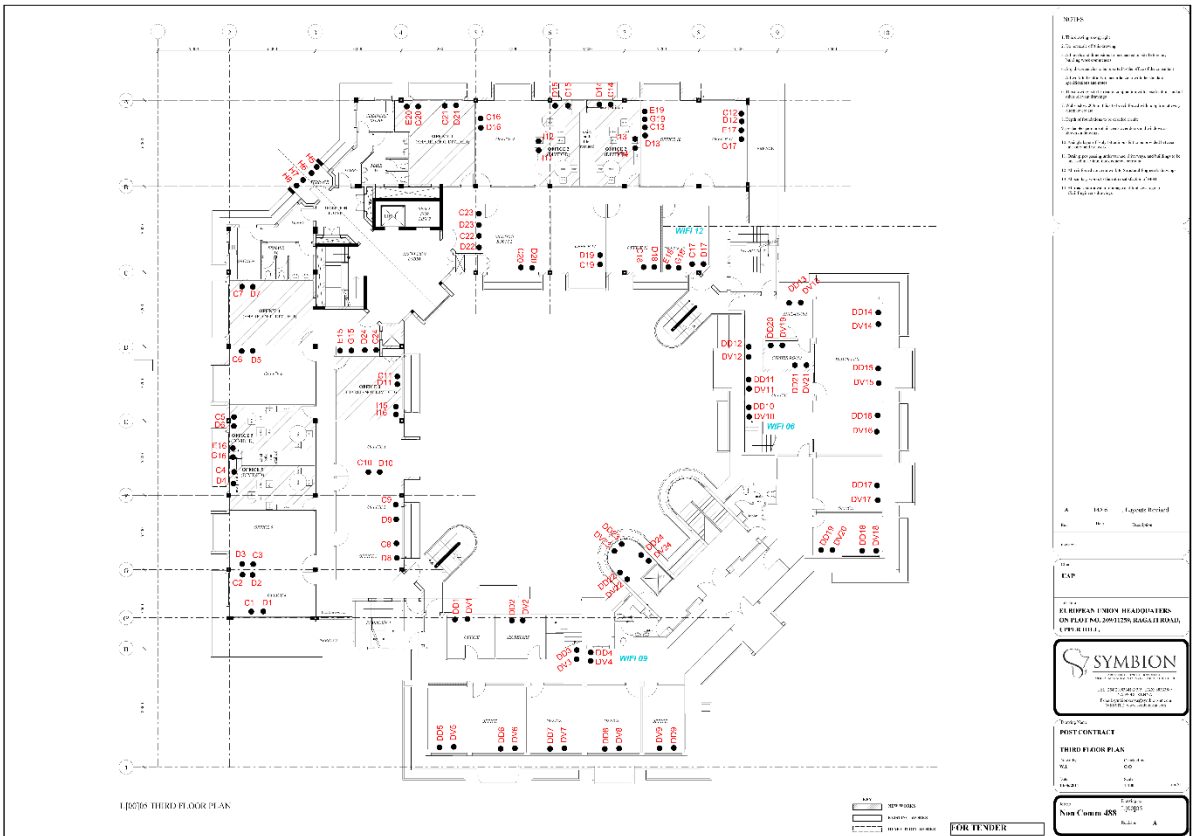

FOURTH FLOOR

